

QUICK START GUIDE

GUÍA DE INICIO RÁPIDO



IMPORTANT READ BEFORE USING

IMPORTANTE LEA ANTES DE USAR

Any questions? ¿Preguntas?
turtlebeach.com/support
 Model: Stealth™ 600 Gen 2 para auriculares de juego para PlayStation®

IMPORTANT

PLEASE MAKE SURE YOUR HEADSET IS UPDATED WITH THE LATEST FIRMWARE.

IMPORTANTE

ASEGÚRATE DE QUE TUS AURICULARES ESTÁN ACTUALIZADOS CON EL ÚLTIMO FIRMWARE.

Connect to the **Turtle Beach Audio Hub** for **Windows** or **Mac®** to update firmware.

Conéctate a la aplicación **Turtle Beach Audio Hub** para **Windows** o **Mac®** para actualizar el firmware.

turtlebeach.com/audiohub



CONTENTS

CONTENIDO

- A** Stealth™ 600 Gen 2 Headset Auriculares Stealth™ 600 Gen 2
- B** Stealth™ 600 Gen 2 Mini Wireless Transmitter Stealth™ 600 Gen 2 Mini transmisor inalámbrico
- C** USB-C Charging Cable Cable de carga USB-C

HEADSET CONTROLS

CONTROLES DE AURICULARES

LED Indication
 See legend
Indicador LED
 Ver leyenda

USB Charge & Update Port
 Puerto USB para carga y actualizaciones

Power Button
 Press [I/s] = Power On/Off
 Press = Superhuman Hearing™ On/Off
Botón de encendido
 Presionado [I/s] = Encender/Apagar
 Presionado = Modo Superhuman Hearing™ activado/desactivado

Master Volume Dial
 Disco de Volumen principal

Variable Mic Monitoring
 Adjust Mic Monitoring levels
Monitor de micrófono variable
 Ajustar los niveles de monitor de micrófono

MODE Button
 Cycle through EQ audio presets
Botón de MODO
 Recorrer los ajustes predefinidos de sonido



Use Superhuman Hearing™ Mode to pinpoint quiet audio cues like enemy footsteps and weapon reloads. During gameplay, you can activate and deactivate Superhuman Hearing™ by pressing the **POWER button once, quickly.**

Utiliza el modo Superhuman Hearing™ para detectar los sonidos más leves, como las pisadas y las recargas de las armas de los enemigos. Durante el juego, puedes activar y desactivar el modo Superhuman Hearing™ al presionar rápidamente el botón de encendido [POWER] una sola vez.

Microphone Mute
 Flip up mic to mute. There is an audible tone when the mic is muted or unmuted.

Silenciar micrófono
 Voltea el micrófono hacia arriba para silenciario. Cuando el modo de silencio se activa o se desactiva, se escucha un tono en los auriculares.

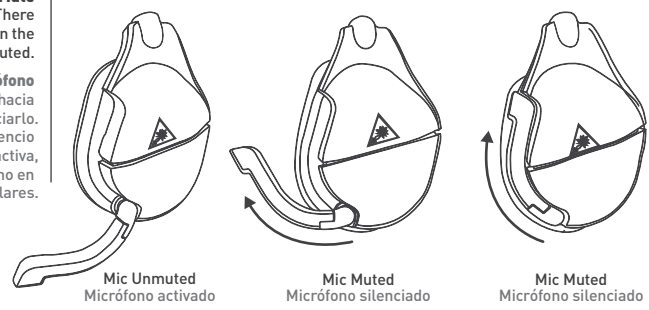

EQ PRESETS | PREAJUSTOS DE AUDIO DEL ECUALIZADOR

Signature Sound | Sonido personalizado

Bass Boost | Potenciador de graves

Bass + Treble Boost | Potenciador de graves y agudos

Vocal Boost | Potenciador de voz

SETUP FOR PLAYSTATION® CONFIGURACIÓN PARA PLAYSTATION®

1 Connect Mini Transmitter to USB Port
 Conecta el mini transmisor al puerto USB

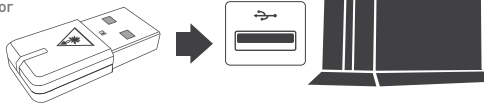

2 Power on Headset
 Enciende los auriculares

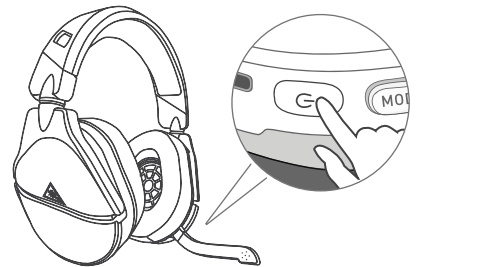

3 Go to **Settings > Devices > Audio Devices**

- a. Select Stealth™ 600 Gen 2 for Input & Output Device
- b. Set Output to Headphones to All Audio
- c. Set Volume Control (headphones) level to maximum
- d. Select Adjust Microphone Level and follow the on-screen instructions to calibrate your microphone

ES Dirígete a **Configuración > Dispositivos > Dispositivos de audio**

- a. Selecciona Stealth™ 600 Gen 2 en la sección de Dispositivo de entrada y salida
- b. Selecciona Todo el sonido para la salida a los audífonos
- c. Ajusta el control de volumen de los audífonos en el nivel máximo
- d. Selecciona Ajustar el nivel del micrófono y sigue las instrucciones en pantalla para calibrar tu micrófono

FR Allez dans **Paramètres > Périphériques > Périphériques Audio**

- a. Sélectionnez Stealth™ 600 Gen 2 comme périphérique d'entrée et de sortie
- b. Réglez Sortie vers le casque sur Tout audio
- c. Mettez le réglage du volume (casque) au maximum
- d. Sélectionnez Réglage le niveau du microphone et suivez les instructions à l'écran pour calibrer votre microphone/your microphone

IT Vai a **Impostazioni > Dispositivi > Dispositivi audio**

- a. Seleziona Stealth™ 600 di seconda generazione per dispositivi di input e output
- b. Imposta Output alle cuffie su Tutto l'audio
- c. Imposta Regolazione volume (cuffie) al livello massimo
- d. Seleziona Regola livello microfono e segui le istruzioni sullo schermo per calibrare il tuo microfono

SE Gå till **Inställningar > Enheter > Ljudenheter/paran**

- a. Välj Stealth™ 600 Gen 2 som enhet för indata och utdata
- b. Ställ in hörlurar som utdata för allt ljud
- c. Ställ in volymkontroll (hörlurar) till max
- d. Välj Juster mikrofonnivån och följ instruktionerna på skärmen för att kalibrera mikrofonen

NL Ga naar **Instellingen > Apparaten > Audioapparaten**

- a. Selecteer Stealth™ 600 Gen 2 als invoer- en uitvoerapparaat
- b. Stel Uitvoer naar hoofdtelefoon in op Alle audio
- c. Stel Volumebediening (hoofdtelefoon) in op het maximum
- d. Selecteer Microfoonniveau aanpassen en volg de instructies op het scherm om je microfoon te kalibreren

PT Acede a **Definições > Dispositivos > Dispositivos de áudio**

- a. Define os auscultadores Stealth™ 600 Gen 2 como dispositivo de entrada e saída
- b. Em Saída para auscultadores, escolhe Todo o áudio
- c. Define o nível de controlo do volume (auscultadores) para o máximo
- d. Selecciona Ajustar o nível do microfone e segue as instruções no ecrã para calibrares o teu microfone

DE Gehe zu **Einstellungen > Geräte > Audio-Geräte.**

- a. Wähle bei Ein- und Ausgangsgeräte: Stealth™ 600 Gen 2 Headset.
- b. Stelle ein, dass alle Sounds über die Kopfhörer ausgegeben werden.
- c. Stelle die Lautstärkenregelung (Kopfhörer) auf die höchste Stufe.
- d. Wähle Mikrofonpegel anpassen und folge den Anweisungen auf dem Bildschirm, um dein Mikrofon einzustellen.

DK Gå til **Indstillinger > Enheder > Lydenheder**

- a. Vælg Stealth™ 600 Gen 2 som Inputenhed og Outputenhed
- b. Angiv Output til hovedtelefoner til Al lyd
- c. Indstil Lydstyrkekontrol (hovedtelefoner) til maksimalt niveau
- d. Vælg Juster mikrofonniveau, og følg instruktionerne på skærmen for at kalibrere din mikrofon.

CHARGING

CARGANDO

The Stealth™ 600 Gen 2 gives you **15 hours** of rechargeable battery life. **Make sure to charge it regularly before storing.**

Los auriculares Stealth™ 600 Gen 2 te ofrecen **15 horas** de juego por cada carga de la batería. **Asegúrate de cargarlos con frecuencia** antes de guardarlos.

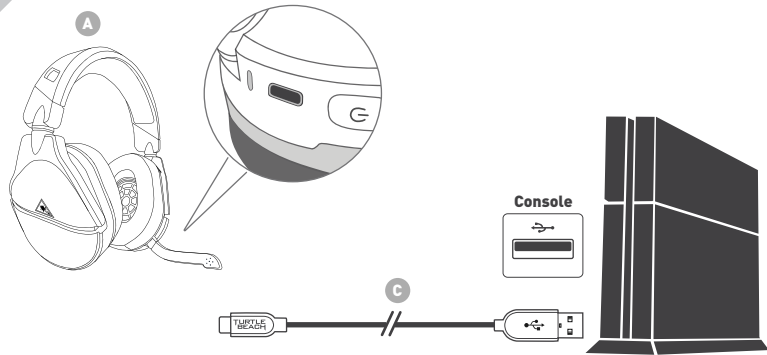

Headset Storage
 Always charge your headset before storing it for any extended period of time (greater than 3 months). Never store the unit in temperatures above 113°F/45°C.

Almacenamiento de los auriculares:
 Antes de un almacenamiento prolongado (más de 3 meses) carga los auriculares. No almacenar el equipo a temperaturas superiores a los 45 °C (113 °F).

LED BEHAVIORS

COMPORTAMIENTOS DE LOS INDICADORES LED

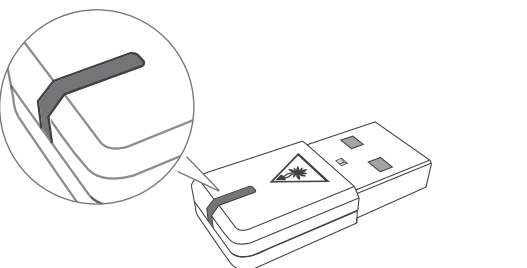

TRANSMITTER LED INDICADOR LED DEL TRANSMISOR	MEANING SIGNIFICADO
Solid Blue Azul constante	Headset and Mini Transmitter Paired Auriculares y mini transmisor emparejados
Double-Blink Blue Azul con doble parpadeo	Not Paired No emparejados
Breathing Red Rojo variable	Mic Muted Micrófono silenciado

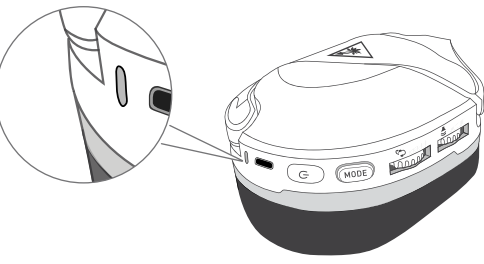

HEADSET LED VOYANT DU CASQUE	MEANING SIGNIFICATION
Solid Blue Azul constante	Headset and Mini Transmitter Paired Auriculares y mini transmisor emparejados
Breathing Blue Azul variable	(While Charging) Battery Full (Durante la carga) Batería llena
Double-Blink Blue Azul con doble parpadeo	Not Paired No emparejados
Solid Red Rojo constante	(While Charging) Battery Charging (Durante la carga) Cargando la batería
Breathing Red Rojo variable	Battery Low Batería baja

PAIRING

EMPAREJAMIENTO

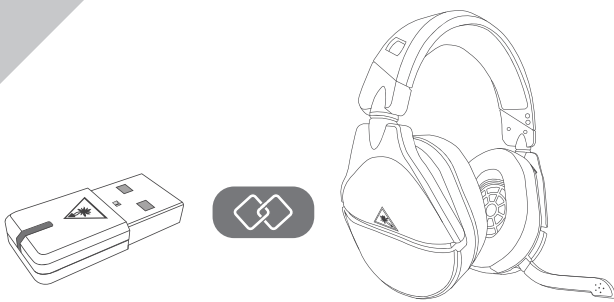

The headset and transmitter are paired out of the box, indicated by a solid LED on the transmitter. If your transmitter's LED is double-blinking, follow the steps to pair your headset and transmitter.

Los auriculares y el transmisor vienen emparejados de fábrica, como lo muestra el indicador LED de color constante en el transmisor. Si el indicador LED de tu transmisor parpadea dos veces, sigue estos pasos para emparejar los auriculares con el transmisor.

1 Connect your Stealth™ 600 Gen 2 for PlayStation® Transmitter into an available USB port on your PlayStation®4 console. Your Transmitter will begin to double blink blue as it searches for your Headset.

Conecta tu transmisor del Stealth™ 600 Gen 2 para PlayStation® a un puerto USB disponible de tu consola PlayStation®4. Tu transmisor empezará a emitir un doble parpadeo azul mientras busca tus auriculares.

2 Power on your Stealth™ 600 Gen 2 for PlayStation® Headset and the LED will begin to double blink blue as it searches for your Transmitter.

Enciende tus auriculares Stealth™ 600 Gen 2 para PlayStation® y el LED empezará a emitir un doble parpadeo azul mientras busca tu transmisor.

5 seconds
5 segundos

3 Within 10 seconds, the Transmitter's and Headset's LED's remain solid, indicating a successful pairing.

En unos 10 segundos los LED del transmisor y de los auriculares emitirán una luz fija para indicar que se han emparejado correctamente.

After 30 seconds, your transmitter will search for both the previously paired headset or any available Stealth™ 600 Gen 2 headset to pair to. Bring the two units closer together to ensure faster pairing.

Tras 30 segundos, tu transmisor empezará a buscar los auriculares emparejados anteriormente u otros auriculares Stealth™ 600 Gen 2 a los que emparejarse. Acerca los dos dispositivos para garantizar un emparejamiento más rápido.

Regulatory Compliance Statements for Stealth™ 600P Gen 2 RX & TX

Local Restrictions on Radio Usage
Caution: Due to the fact that the frequencies used by wireless devices may not yet be harmonized in all countries, these radio products are designed for use only in specific countries, and are not allowed to be operated in countries other than those of designated use. As a user of these products, you are responsible for ensuring that the products are used only in the countries for which they were intended and for verifying that they are configured with the correct selection of frequency and channel for the country of use. Any deviation from the permissible power and frequency settings for the country of use is an infringement of national law and may be punished as such.

To determine whether you are allowed to use your wireless network device in a specific country, please check to see if the radio type number that is printed on the identification label of your device is listed in the manufacturer's OEM Regulatory Guidance document at the following URL: <http://www.turtlebeach.com/homologation> or contact Turtle Beach directly.

Federal Communications Commission (FCC) Compliance Notices

- FCC ID: XGB-TB3140 (RX) & XGB-TB3141 (TX)
- Non-Modification Statement
- Class B Interference Statement
- RF Radiation Exposure & Hazard Warning

Class B Interference Statement

This equipment has been tested and found to comply with the limits for a Class B digital device, pursuant to Part 15 of the FCC Rules. The limits are designed to provide reasonable protection against harmful interference in a residential installation. This equipment generates, uses, and can radiate radio frequency energy and, if not installed and used in accordance with the instructions, may cause harmful interference to radio communications. However, there is no guarantee that interference will not occur in a particular installation. If this equipment doesn't cause harmful interference to radio or television reception, which can be diminished by turning the equipment off and on, the user is encouraged to try to correct the interference by one or more of the following measures:

- Reorient or relocate the receiving antenna.
- Increase the separation between the equipment and receiver.
- Connect the equipment into an outlet on a circuit different from that to which the receiver is connected.
- Consult the dealer or an experienced radio/TV technician for help.

FCC Caution:

This device complies with Part 15 of the FCC Rules. Operation is subject to the following two conditions: (1) This device may not cause harmful interference, and (2) This device must accept any interference received, including interference that may cause undesired operation.

RF Radiation Exposure & Hazard Statements

To ensure compliance with FCC RF exposure requirement, this device must be installed in a location such that the antenna of the device will be greater than 2 cm (0.8 in.) from all persons. Using higher gain antennas and types of antennas not covered under the FCC certification of this product is not allowed. Installers of the radio and users of the product must adhere to the installation instructions provided in this manual. This transmitter must not be co-located or operated in conjunction with any other antenna or transmitter.

Non-Modification Statement

Use only the supplied internal antenna. Unauthorized antennas, modifications, or attachments could damage the Stealth™ 600P Gen 2 RX & TX Models and violate FCC regulations. Any changes or modifications not expressly approved by the party responsible for compliance could void the user's authority to operate this equipment. Please contact Turtle Beach for a list of approved 2.4 GHz antennas.

This product is compliant with the Consumer Product Safety Improvement Act of 2008, Public Law 110-314 (CPSIA)

Canadian ICES Statements IC:

3879A-3140 (RX) and IC: 3879A-3141 (TX)
 This device complies with ICES-003 and RSS-247 of Industry Canada. Operation is subject to the following two conditions:
 1. This device may not cause interference, and
 2. This device must accept any interference, including interference that may cause undesired operations of the device.

Ce dispositif est conforme aux normes NMB003 et CNR-217 d'Industrie Canada

Son fonctionnement est soumis aux deux conditions suivantes :
 1. Ce dispositif ne doit pas causer d'interférences nuisables etc.
 2. Il doit pouvoir accepter les interférences, incluant celles pouvant nuire à son fonctionnement normal.
 To prevent radio interference to the licensed service (i.e. co-channel Mobile Satellite systems) this device is intended to be operated indoors and away from windows to provide maximum shielding. Equipment (or its transmit antenna) that is installed outdoors is subject to licensing and not supported by Stealth™ 600P Gen 2 RX & TX Models.
 Pour éviter les interférences radio au service agréé (i.-à-d. Les systèmes par satellite mobile co-canal), cet appareil est destiné à fonctionner à l'intérieur et à l'extérieur des fenêtres pour assurer un blindage maximal. L'équipement (ou son antenne d'émission) installé à l'extérieur est soumis à l'octroi de licences et n'est pas pris en charge par les modèles Stealth™ 600P Gen 2 RX & TX.

RF Radiation Exposure & Hazard Statement

To ensure compliance with RSS-102 RF exposure requirements, this device must be installed in a location such that the antenna of the device will be greater than 2 cm (0.8 in.) away from all persons. Using higher gain antennas and types of antennas not covered under the IC certification of this product is not allowed. Installers of the radio and end users of the product must adhere to the installation instructions provided in this manual. This transmitter must not be co-located or operated in conjunction with any other antenna or transmitter.
Exposition aux radiations RF & Mention de danger
 Pour assurer la conformité avec les exigences RSS-102 d'exposition aux RF (Radio Fréquences), cet appareil doit être installé dans un endroit où l'antenne de l'appareil sera située à une distance de plus de 2 cm (0,8 po) de toutes personnes. L'utilisation d'antennes de gain plus élevées et les types d'antennes qui ne sont pas couvertes en vertu de la certification d'IC de ce produit n'est pas autorisée. Les installateurs de la radio et les utilisateurs du produit final doivent se conformer aux Instructions d'installation fournies dans ce manuel. Cet émetteur ne doit pas être co-implanté ou exploité en conjonction avec toute autre antenne ou transmetteur.

European Union and European Fair Trade Association Regulatory Compliance

This equipment may be operated in the countries that comprise the member countries of the European Union and the European Fair Trade Association. These countries, listed below, are referred to as The European Community throughout this document: AUSTRIA, BELGIUM, BULGARIA, CYPRUS, CZECH REPUBLIC, DENMARK, ESTONIA, FINLAND, FRANCE, GERMANY, GREECE, HUNGARY, IRELAND, ITALY, LITHUANIA, LUXEMBOURG, MALTA, NETHERLANDS, POLAND, PORTUGAL, ROMANIA, SLOVAKIA, SLOVENIA, SPAIN, SWEDEN, UNITED KINGDOM, ICELAND, LICHTENSTEIN, NORWAY, SWITZERLAND.

Declaration of Conformity

CE
 Marking by this symbol:
 Indicates compliance with the Essential Requirements of the Radio Equipment Directive (RED) of the European Union (2014/53/EU).
 This equipment meets the following conformance standards:

- EN 60950-1: 2006 + A11: 2009 + A1: 2010 + A12: 2011 + A2: 2013 (IT-Mark License), IEC 60950-1: 2005 (2nd Ed.) + Am 1: 2009 + Am 2: 2013 (CB Scheme Certificate), EN 62369-1: 2014 + A11 (IT-Mark License), IEC 62369-1: 2014 (CB Scheme Certificate), EN 60335-1: 2013, EN 60332-2: 2013, EN 71-3: 2013
- Additional licenses issued for specific countries available on request.

EMC:

EN 55032: 2015, CISPR 32: 2015,
 EN 301 489-1 v2.1.1 (2017-02), EN 301 489-17 v3.1.1 (2016-11), EN 61000-4-2: 2009, EN 61000-4-3: 2008 + A1: 2008 + A2: 2010, EN 61000-4-8: 2010

The products are licensed, as required, for additional country specific standards for the International Marketplace. Additional issued licenses available upon request.

Radio: EN 300 328 V2.1.2 (2019-07)

SAR: EN 62311:2008

Environmental:

RoHS 2015/863 amending Annex II to 2011/65/EU, WEEE 2012/19/EU, REACH 2006/1907/EC, Packaging 94/62/EC, Battery 2006/66/EC, Toys Safety Directive 2009/48/EC

WARNING!
 This is a Class B product. In a domestic environment, this product may cause radio interference, in which case, the user is required to take appropriate measures.

ACHTUNG!
 Dieses ist ein Gerät der Funkstrahlengrenzwertklasse B. In Wohnbereichen können bei Betrieb dieses Gerätes Rundfunkstörungen auftreten, in welchen Fällen der Benutzer für entsprechende Gegenmaßnahmen verantwortlich ist.

ATTENTION!
 Ceci est un produit de Classe B. Dans un environnement domestique, ce produit risque de créer des interférences radioélectriques, il appartient alors à l'utilisateur de prendre les mesures préconisées appropriées.

Recycling Symbol
 This symbol on the product or its packaging indicates that this product must not be disposed of with your other household waste. Instead, it is your responsibility to dispose of your waste equipment by handing it over to a designated collection point for the recycling of waste electrical and electronic equipment. The separate collection and recycling of your waste equipment at the time of disposal will help conserve natural resources and ensure that it is recycled in a manner that protects human health and the environment. For more information about where you can drop off your waste for recycling, please contact your local authority, or where you purchased your product.

Turtle Beach Europe Ltd is obligated as a producer with a main activity of selling under the Producer Responsibility Obligations (Packaging Waste) Regulations 2007. To fulfil our obligation we are registered with Comply Direct and their Recycling Room. Here you will find advice and information on packaging waste management, recycling symbols and the waste hierarchy principles of reduce, reuse and recycle. <https://www.complydirect.com/the-recycling-room/>

Please visit the following URL for a complete copy of the Declaration of Conformity: <http://www.turtlebeach.com/homologation>

Mexican IFT-008 Compliance Statement

"La operación de este equipo está sujeta a las siguientes dos condiciones: (1) es posible que este equipo o dispositivo no cause interferencia perjudicial y (2) este equipo o dispositivo debe aceptar cualquier interferencia, incluyendo la que pueda causar su operación no deseada."

Not seeing what you're looking for here?

Visit turtlebeach.com/support for the latest Tech Support information.

¿Tienes alguna duda?

Visita es.turtlebeach.com/pages/servicio-asistencia para obtener la información más reciente de soporte técnico.

To access the rating label: Para acceder a la etiqueta de evaluación:

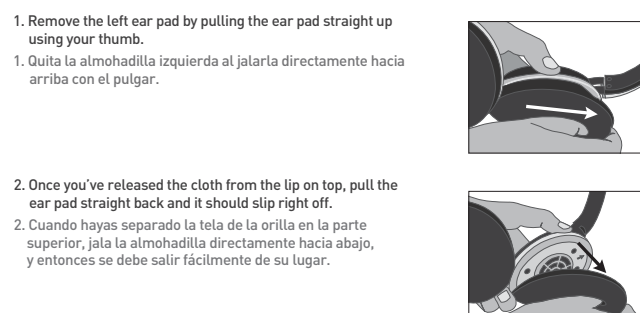

To replace the ear pad, follow the same process in reverse. Para reemplazar la almohadilla, sigue el mismo proceso en orden inverso.